

1:500 LANDSCAPE MASTERPLAN

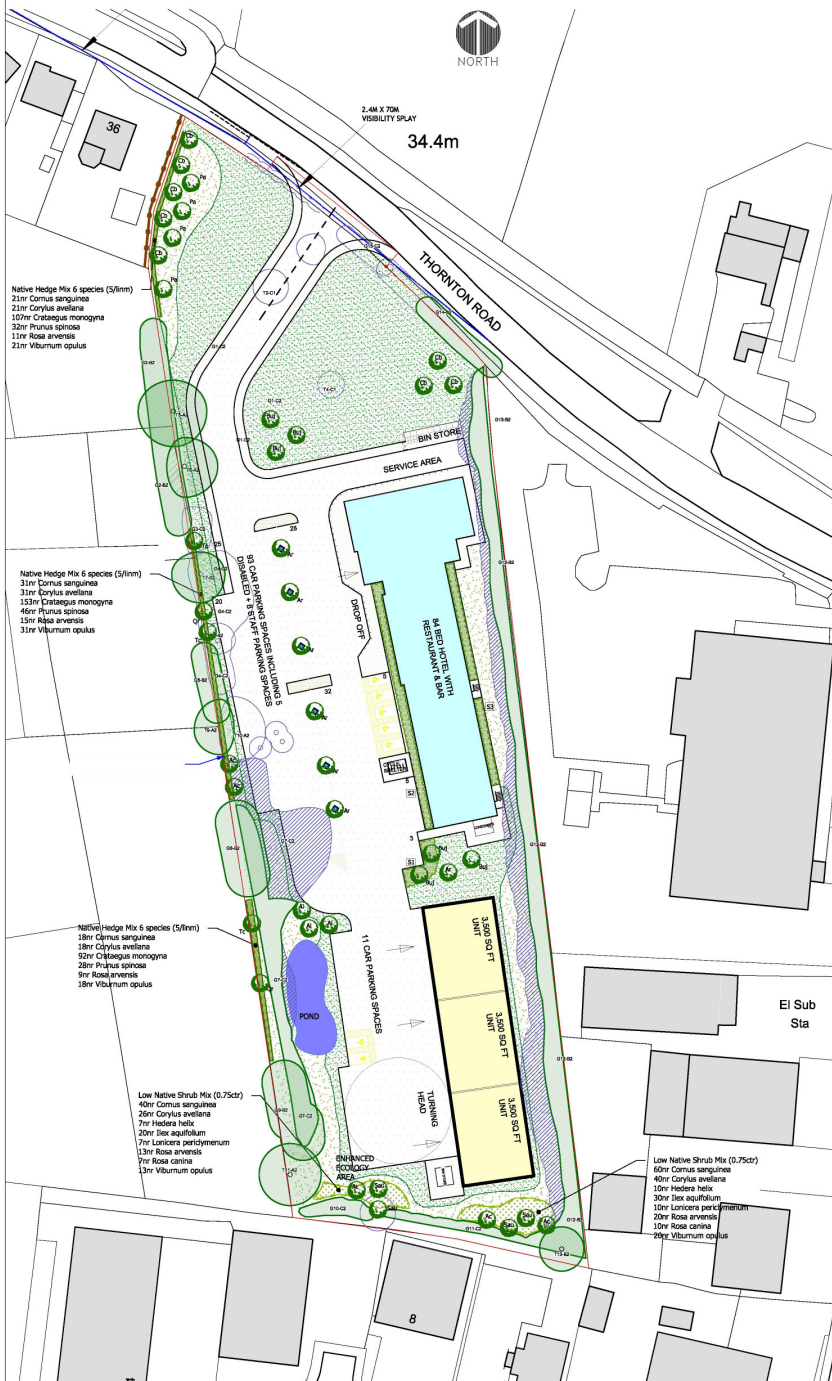

PLANTING SCHEDULES

TREE SCHEDULE		NUMBERS REQUIRED
SPECIES	Ht in m	4.5 min
	Girth in cm	16-18
Acer campestre (Ac)		5
Acer rubrum (Ar)		7
Alnus incana (Al)		3
Betula utilis jacquemontii (Bu)		6
Carpinus betulus (Cb)		8
Prunus avium (Pa)		4
Quercus robur (Qr)		2
Sorbus aucuparia (Su)		4
Tilia cordata (Tc)		3

All trees to have clear stems to 1.8m above ground level with well developed branching heads with a single central leader and healthy, fibrous root systems. Trees shall be either container grown or rootballed in accordance with season of planting. Trees shall be planted into pits of an appropriate size to accommodate the root system without restriction, backfilled with a 3:1 topsoil:compost mix and shall be secured to a machine rounded stake using 1 no. tree tie with rubber spacer. Finished height of stake shall not exceed 1/2 height of staked tree above ground. Foundation design of new buildings shall accommodate proposed tree planting in accordance with HVC guidelines.

NATIVE HEDGE

NATIVE HEDGE SCHEDULE					
Nr	Name	Height/cm	Age	Root	Pot/L
70	Cornus sanguinea	60-80cm	1/1	B	
70	Corylus avellana	60-80cm	1/2	B	
352	Crataegus monogyna	60-80cm	1/1	B	
106	Prunus spinosa	60-80cm	1/0	B	
35	Rosa arvensis	50-60cm	1/1	B	
70	Viburnum opulus	50-60cm	1/1	B	

Hedge to be planted in a previously prepared trench, 500mm wide and 450mm deep backfilled with 3:1 mix of multipurpose topsoil to BS3883:2007 and planting compost. Bare-root transplants to be dipped in a suitable mycorrhizal dip before planting. Plants to be planted in a double staggered row, 300-350mm wide, at 5m plants per linear metre with species planted randomly throughout in groups of 7 to 30 of a single species. The hedge lines shall be mulched after planting with forest mulch to a uniform depth of 50mm. Where the hedge is to be planted within 10 metres of any house the Hawthorn (Crataegus monogyna) shall be excluded from the mix.

NATIVE SHRUB MIX

NATIVE SHRUB MIX SCHEDULE					
Nr	Name	Height/cm	Age	Root	Pot/L
100	Cornus sanguinea	40-60cm	1/1	B	
60	Corylus avellana	40-60cm	1/1	B	
17	Hedera helix	40-60cm		C	2L
50	Ilex aquifolium	40-60cm		C	3L
17	Lonicera periclymenum	60-80cm		C	2L
33	Rosa arvensis	50-60cm	1/1	B	
17	Rosa canina	40-50cm	1/1	B	
33	Viburnum opulus	40-60cm	1/1	B	

Native species shall be planted into 450mm depth, good quality clean topsoil incorporating organic compost and slow release fertilizer, over an compacted sub-grade. Prior to planting all bare-root plant stock shall be dipped into a suitable mycorrhizal plant dip in accordance with the manufacturer's recommendations. Plants shall be planted in groups of 3-11 of a single species with the taller growing species to the back of the areas of the areas and the lower growing species to the edges of the areas. Planted areas to be mulched after planting with coarse grade forest mulch to a uniform depth of 50mm.

GRASS SEEDING AREAS

**SPECIES RICH MIX**  
Subsoil to be cultivated using a disc harrow or rotavator, to 30mm depth then further cultivated and rolled to produce a firm seed bed.  
A species rich grass seed mix such as Emergence ELL mix shall be sown to the specified areas at the supplier's recommended rates.

TURFING

The topsoiled area to be turfed, is to be grade and cross-graded to even running falls, to allow the finished levels of the turf to be 40mm above the adjoining paved areas. The surface should be lightly and uniformly firmed by rolling or treading and reduced to a free fall up to 25mm in depth. All rubbish, stones greater than 50mm in diameter etc. shall be removed from the surface. Apply an even application of approved fertilizer at a rate of 70g/m<sup>2</sup> and rake in. No turves shall be laid in exceptionally frosty weather or in other unsuitable weather conditions. The turves shall be laid in a stretcher bond pattern, closely butted and firmed into position, to the correct levels. The turves should be laid off plants, working over turves previously laid. A dressing of fine, sifted topsoil (complying with BS 3882) should be applied to the laid turf and brushed well into the joints. Turves shall be watered regularly to prevent them drying out before they establish.

KEY

- Existing trees, hedges and vegetation to be retained
- Existing trees, hedges and vegetation to be removed
- Existing vegetation cut back and managed to create a healthy and practical boundary
- Proposed Extra heavy standard (14-16cm girth) tree
- Proposed Extra heavy standard (14-16cm girth) tree set in tree grille with raised kerb edge (SD/7/54)
- Proposed native hedge
- Proposed ornamental shrub planting
- Proposed native species tree and shrub planting
- Proposed turf
- Proposed species rich meadow mix

**REVISED PLAN**

Date Valid 05/08/2019

THIS COPY HAS BEEN MADE BY OR WITH THE AUTHORITY OF RYEDALE DISTRICT COUNCIL PURSUANT TO SECTION 47 OF THE COPYRIGHT DESIGNS AND PATENTS ACT 1988. UNLESS THAT ACT PROVIDES A RELEVANT EXCEPTION TO COPYRIGHT, THE COPY MUST NOT BE COPIED WITHOUT THE PRIOR PERMISSION OF THE COPYRIGHT OWNER.

Rev.E: Removal of RPA for clarity (see Tree Report by Quants for detail) (SF) July 2019  
Rev.D: Layout amended in line with Proposed Site Plan Rev M (SF) July 2019  
Rev.C: Layout amended in line with Proposed Site Plan Rev L (SCL) June 2019  
Rev.B: T7 retained (SF) March 2019  
Rev.A: Updated in accordance with HVC layout Rev.F (SF) March 2019

<p>Rev Farmer to show all Landscape Activities</p> <p>fdalandscape</p> <p>Westgate Hat Waterfield Road Derry Dale Huddersfield HD3 5GJ Telephone 01484 866616 for 01484 866666 1611 01484 866600 email info@fdalandscape.co.uk www.fdalandscape.co.uk</p>	<p>client <b>Jornast</b></p> <p>project <b>THORNTON RD, PICKERING</b></p> <p>drawing title <b>LANDSCAPE DETAILS</b></p> <p>scale 1:500</p> <p>date March 19</p> <p>drawn by SF</p> <p>checked by R/2216/1E</p>
---	--